

## IMPORTANT - CARE OF YOUR PRODUCT

### AFTER INSTALLATION

After installation we strongly recommend that the fitting be securely covered to prevent contamination or damage by any form of building materials such as paint, plaster, tile adhesive, grout or sealants until all building and finishing work is completed.

### CLEANING

After use all finishes should be maintained by wiping with a soft, damp, clean cloth and then polished using a soft dry duster. **NO** abrasive powder, detergents or polishes should be used, cleansers containing alcohol, acid or corrosive chemicals should **NOT** be used.

### NOTE

Some household bleaches and denture cleaners can damage plated or coloured finishes and if spilt on to a fitting should be washed off immediately with cold water.

If these instructions are followed we believe this fitting will give many years of satisfactory use.

We have a policy of continuous improvement and reserve the right to change specifications without notice.

Please retain this document for future reference.

If you have any comment regarding these fittings and instructions we invite you to write to:

The Managing Director  
Marflow Engineering Limited  
Britannia House  
Austin Way, Hamstead Industrial Estate  
Birmingham, B42 1DU

© 2006 Marflow Engineering Limited. All rights reserved. No part of this publication may be reproduced, photocopied, stored on a retrieval system, or transmitted without the express written permission of Marflow Engineering Limited.

## INSTALLATION AND USER INSTRUCTIONS

SINGLE LEVER MONO BASIN MIXER WITH POP UP WASTE	ASC.415	DATE JAN 2010
--	---------	------------------



# Marflow

EDWARDS & CO

Guaranteed.  
Manufactured under BSI Registered International Quality System BS EN IS9001:2000  
Certificate number : FM57646

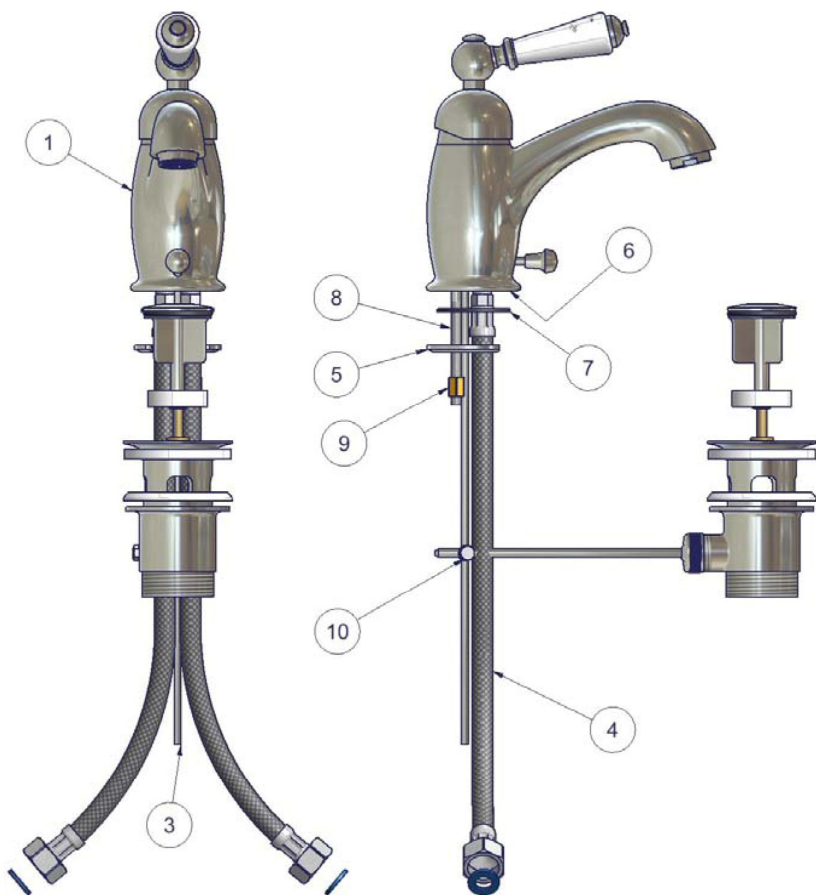

### Water Supplies

The taps are suitable for installation on low pressure, vented or unvented high pressure and pumped systems.

### Water Regulations

These taps should be installed in compliance with any water regulations applying to the Location/State/Country in which they are being fitted.

### Installation

1. Before connecting the mixer, water should be flushed through the pipework to remove all debris.
2. Unscrew knob from rod (3). Fit rod through the hole in the mixer from underneath, screw knob onto rod (3).
3. Screw the threaded stud (8) and tails (4) into the mixer body.
4. Insert the fitting through the hole in the ware rim ensuring that gasket (6) is in place between the body of the mixer and the ware.
5. Tighten the fixing nut (9) onto, the threaded stud (8) to firmly secure the fitting. Ensure 'C' clamp (5) and washer (7) are between the underside of the ware and the fixing nut.
6. Connect the hot and cold supplies referring to the previous paragraph.
7. Fit and connect the waste assembly with the swivel arm pointing to the rear. Connect the swivel arm to the pop-up rod (3) with the screw lock adjuster (10). Adjust the lift of the waste plug to suit. Surplus rod can now be cut off to avoid fouling the wall or waste pipes.
8. Turn on the hot and cold

supplies and check for leaks.

### Maintenance

Should a tap drip when fully turned off, turn off the water supplies and remove the cartridge. This is done by removing the handle, unscrewing the cartridge cover to reveal the cartridge hexagon. Check that there is no debris, calcium or scale build up. The cartridge can be carefully cleaned by soaking in a descalant. If damage has occurred a new complete cartridge will be required.